

RoHS
COMPLIANCE

≤±0.03%

DIMENSIONS (mm.)

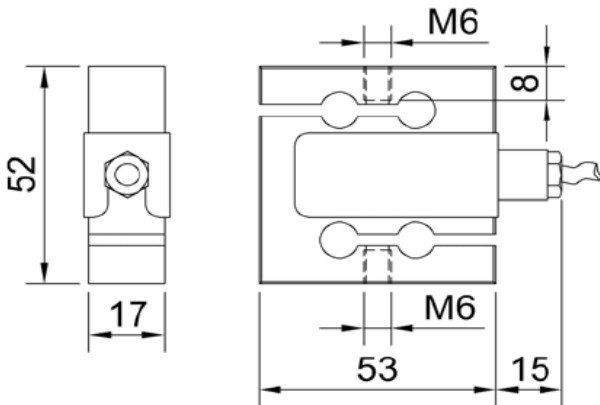

LOAD	KHz ⁽¹⁾
1 kg	0.22
2 kg	0.50
5 kg	0.75
10 kg	1.00
25 kg	1.50
50 kg	2.00

APPLICATIONS(mm.)

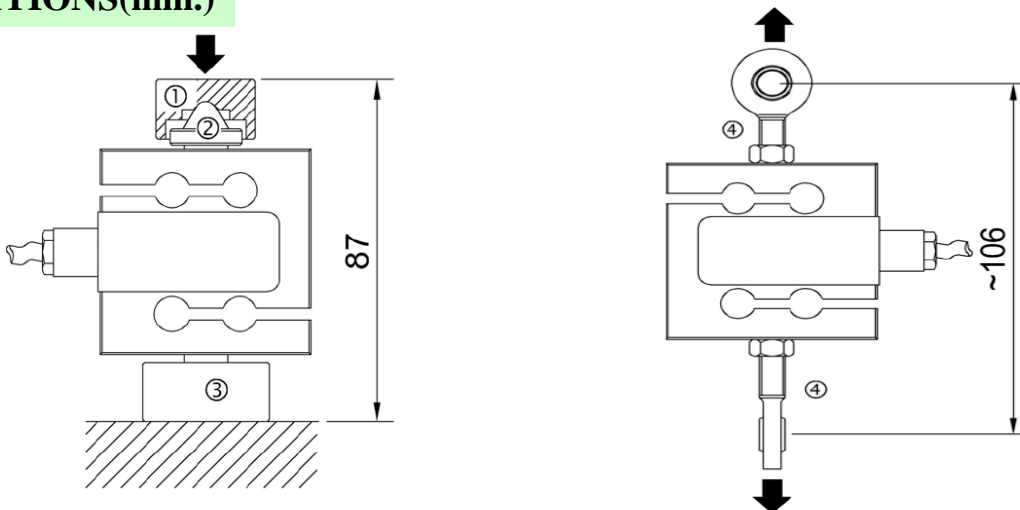

WARNING :

*Be sure that the force exerted when assembling accessories does not exceed nominal load
Cable weight can influence measurement, it is therefore recommended to place it at the opposite site of the load.*

TECHNICAL DATA

NOMINAL LOAD	1 ⁽¹⁾ - 2 ⁽¹⁾ - 5 ⁽¹⁾ - 10 - 25 - 50 kg ⁽²⁾
NOMINAL SENSITIVITY	2mV/V
SENSITIVITY TOLERANCE	≤ ±0.1%
TEMPERATURE EFFECT (10 °C)	
a) on zero	≤ ±0.025%
b) on sensitivity	≤ ±0.021%
LINEARITY	≤ ± 0.03%
HYSTERESIS	≤ ± 0.03%
REPEATABILITY	≤ ±0.01%
INPUT RESISTANCE	440 ± 20 Ω
OUTPUT RESISTANCE	350 ± 2 Ω
INSULATION RESISTANCE	>5 GΩ
ZERO BALANCE	≤ ± 1%
RECOMMENDED SUPPLY VOLTAGE	10 V
NOMINAL SUPPLY VOLTAGE	1-15 V
MAXIMUM SUPPLY VOLTAGE	18 V
MECHANICAL LIMIT VALUES REFERRED TO NOMINAL LOAD :	
a) service load	120%
b) max permissible load	150%
c) breaking load	>300%
d) max transverse load	50%
e) max permissible dynamic load	50%
DISPLACEMENT AT NOMINAL LOAD	~ 0.3 mm
REFERENCE TEMPERATURE	+23°C
TEMPERATURE NOMINAL RANGE	-10/+40 °C
SERVICE TEMPERATURE	-20/+70 °C
STORAGE TEMPERATURE	-20/+80 °C
WEIGHT	~ 0.3 kg
PROTECTION CLASS (EN 60529)	IP20
EXECUTION MATERIAL	Alluminio / Aluminium
CABLE LENGTH	3 m
RECOMMENDED KNUCKLE JOINTS	DURBAL EM6

¹⁾ Supplied with overload protection tension and compression (Max. 500% F.S.).

⁽²⁾ N calibrations on request

ELECTRICAL CONNECTIONS

PVC 70°C shielded cable, Ø 4.2mm with 4 tinned Ø 0.14mm² conductors.

Connected to the body of the load cell.

